

XY Motorized Piezo Stages



2023 V1

For customized projects please Contact us:

info@simtrum.com

XY Motorized Piezo Stages - ST-XY2-2550

Our ST-XY2-2550 is a XY motorized piezo stage. It has 50x25mm stroke and repeatability up to +/-200nm, with a maximum load capacity up to 1kg.

Feature

- Piezoelectric motor drive, self-locking when power off, saving energy and reducing heat generation
- Simple and compact design
- Grating feedback, optional resolution
- Can be used in optical assembly, micro-nano processing, laser, automation and other fields



Specification

Model	ST-XY2-2550
Stroke(mm)	50*25
Driver	Piezoelectric Motor
Maximum Load Capacity(KG)	1
Maximum Speed(mm/s)	100
Minimum Step Size(nm)	50(Grating Feedback)
Repeatability(nm)	+/-200
Position Sensor	Grating
Material	Aluminum Alloy
Weight(KG)	1.5

Drawings

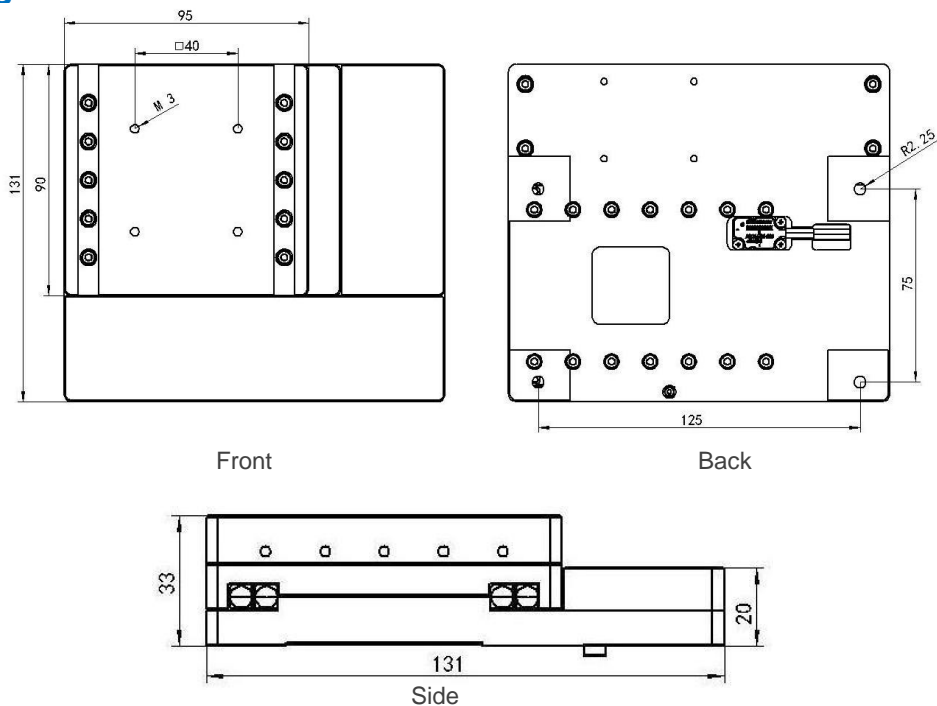

XY Motorized Piezo Stages - ST-XY3-5050

Our ST-XY3-5050 is a integral XY motorized piezo stage. It has 50x50mm stroke and repeatability up to +/-200nm, with a maximum load capacity up to 5kg.

Feature

- Piezoelectric motor drive, self-locking when power off, saving energy and reducing heat generation
- Simple and compact design
- Grating feedback, optional resolution
- Can be used in optical assembly, micro-nano processing, laser, automation and other fields



Specification

Model	ST-XY3-5050
Stroke(mm)	50*50
Driver	Piezoelectric Motor
Maximum Load Capacity(KG)	5
Maximum Speed(mm/s)	100
Minimum Step Size(nm)	50
Repeatability(nm)	+/-200
Position Sensor	Grating
Material	Aluminum Alloy
Weight(KG)	3

Drawings

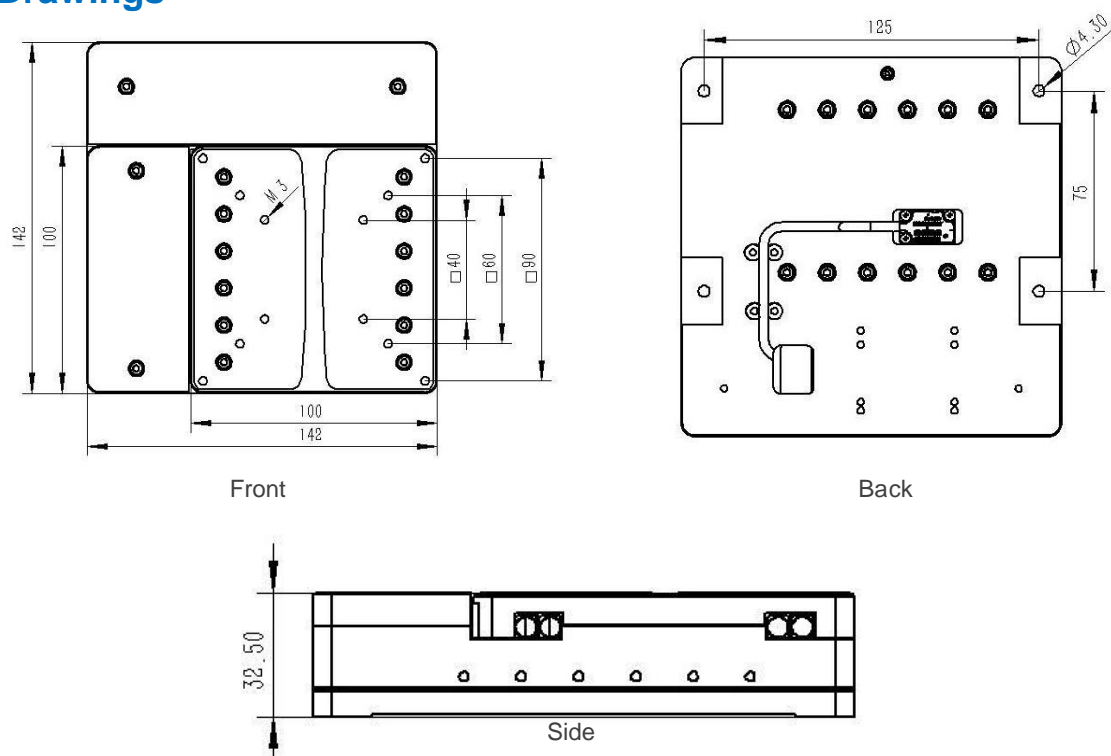

XY Motorized Piezo Stages - ST-XY3-7575

Our ST-XY3-7575 is a Integral XY motorized piezo stage. It has 75x75mm stroke and repeatability up to +/-200nm, with a maximum load capacity up to 3kg.

Feature

- Piezoelectric motor drive, self-locking when power off, saving energy and reducing heat generation
- Simple and compact design
- Grating feedback, optional resolution
- Can be used in optical assembly, micro-nano processing, laser, automation and other fields



Specification

Model	ST-XY3-7575
Stroke(mm)	75*75
Driver	Piezoelectric Motor
Maximum Load Capacity(KG)	3
Maximum Speed(mm/s)	100(Open Loop)
Minimum Step Size(nm)	50
Repeatability(nm)	+/-200
Position Sensor	Grating
Material	Aluminum Alloy
Weight(KG)	2.2

Drawings

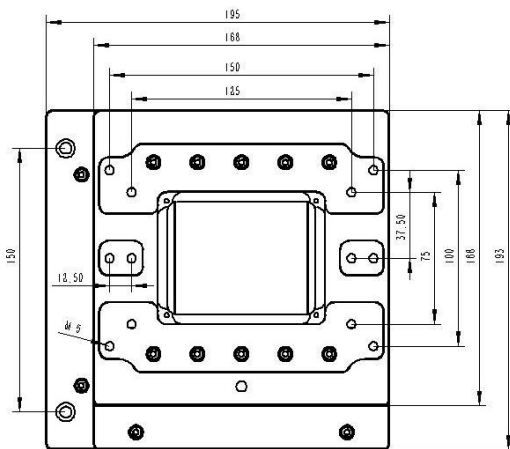

Front

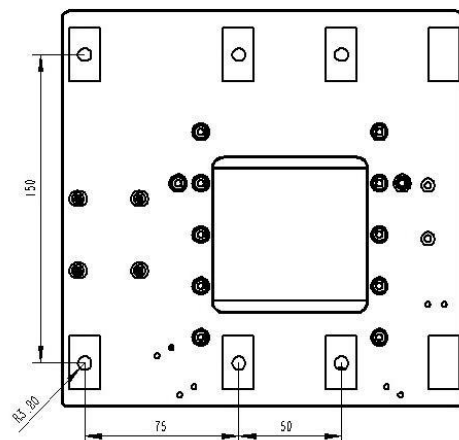

Back

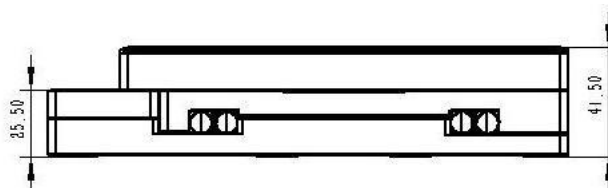

Side

XY Motorized Piezo Stages - ST-XY3-105105

Our ST-XY3-105105 is a two-dimensional motorized piezo stage. It has 105x105 mm stroke and repeatability up to +/-200nm, with a maximum load capacity up to 2kg.

Feature

- Piezoelectric motor drive, self-locking when power off, saving energy and reducing heat generation
- Simple and compact design
- Grating feedback, optional resolution
- Can be used in optical assembly, micro-nano processing, laser, automation and other fields



Specification

Model	ST-XY3-105105
Stroke(mm)	105*105
Driver	Piezoelectric Motor
Maximum Load Capacity(KG)	2
Maximum Speed(mm/s)	100
Minimum Step Size(nm)	20(50,100nm for option)
Repeatability(nm)	+/-200
Position Sensor	Grating
Material	Aluminum Alloy
Weight(KG)	4.52

Drawings

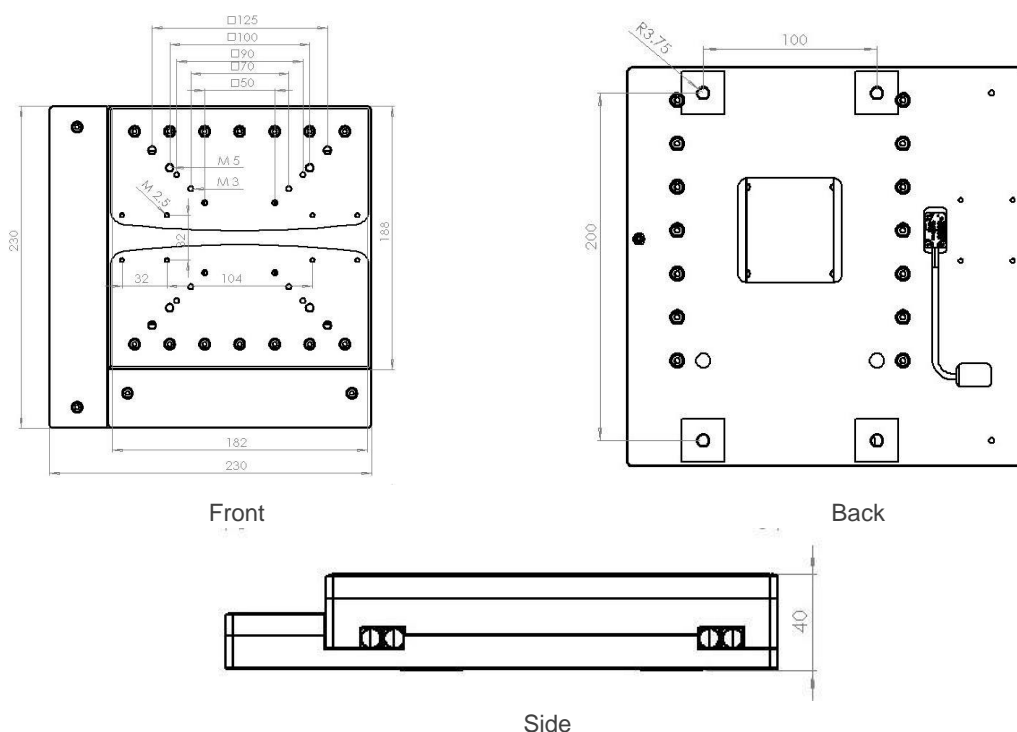

XY Motorized Piezo Stages - ST-XY4-150150

Our ST-XY4-150150 is a two-dimensional motorized piezo stage. It has 105x105 mm stroke and repeatability up to +/-200nm, with a maximum load capacity up to 10kg.

Feature

- Piezoelectric motor drive, self-locking when power off, saving energy and reducing heat generation
- Simple and compact design
- Grating feedback, optional resolution
- Can be used in optical assembly, micro-nano processing, laser, automation and other fields



Specification

Model	ST-XY4-150150
Stroke(mm)	150*150
Driver	Piezoelectric Motor
Maximum Load Capacity(KG)	10
Maximum Speed(mm/s)	50
Minimum Step Size(nm)	20(50,100nm for option)
Repeatability(nm)	+/-200
Position Sensor	Grating
Material	Aluminum Alloy
Weight(KG)	10

Drawings

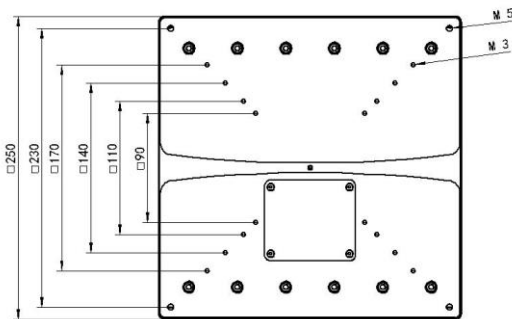

Front

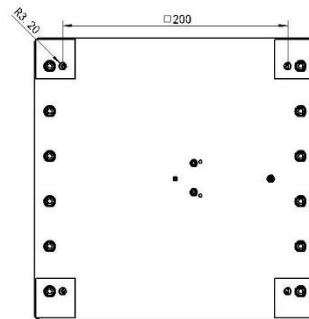

Back

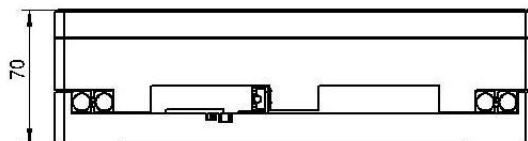

Side